

# Product Information Sheet

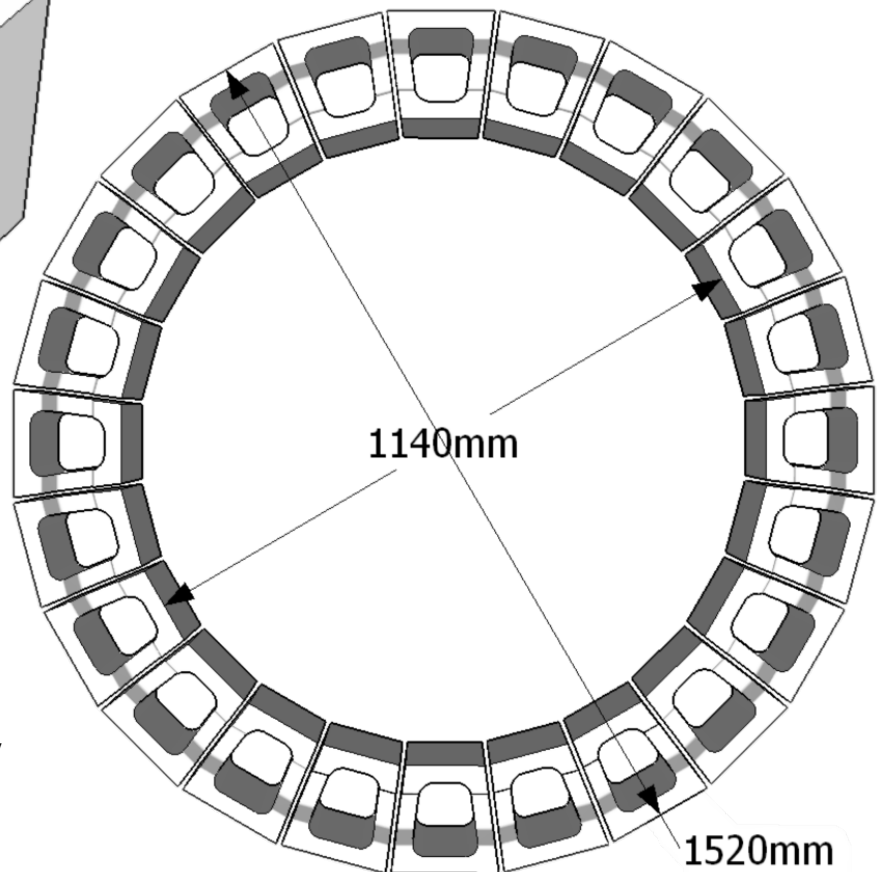

- Description:** 190mm 'Half-Length Channel Curve Wall' light weight
- Product Code:** 20-03C (M2003CLANAT00LW)
- Dimensions:** 190 x 190/140 x 190 mm (W x L x H) (+/- Tolerance to AS 4455.1)  
Minimum face shell thickness 30mm
- Strength:** Characteristic Unconfined Compressive Strength  $\geq 15$  MPa
- Fire Resistance:** 90/90/90 (Srf  $\leq 17$ ) hollow\*  
240/240/240 (Srf  $\leq 15$ ) core-filled unreinforced\*  
240/240/240 (Srf  $\leq 36$ ) core-filled reinforced\*
- Durability:** Exposure Grade\*\* (determined by Resistance to Salt Attack)
- Weight:** 6.3 Kg +10%
- No. Per Pallet:** 180 Units
- No. Per m<sup>2</sup>:** 25 Units
- Wall Curve:** 570mm inner / 760mm outer radius (with regular 10mm joint)  
1140mm inner / 1520mm outer diameter (with regular 10mm joint)  
Sharper or shallower curves are achievable by varying the joint widths

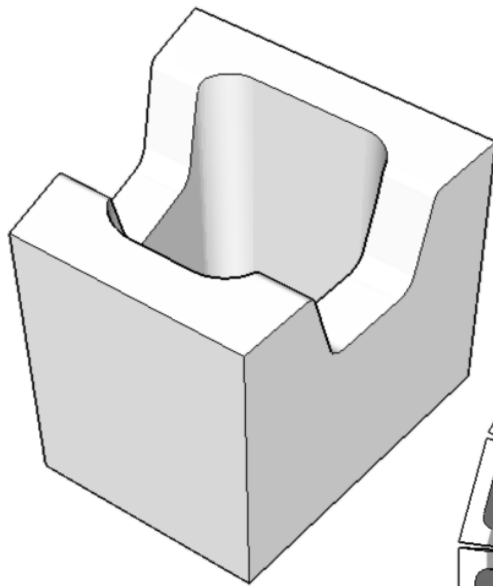

Manufactured to AS/NZS 4455.1:2008.

\* Fire Resistance Levels DTS as per AS3700.

\*\* Durability as per BMRL Research Laboratory test certificate #8263, AS/NZS 4456.10 Method B.

The information above is for general description purposes only.

24/11/2020 - subject to change without notice.