

# PRODUCT INFORMATION SHEET

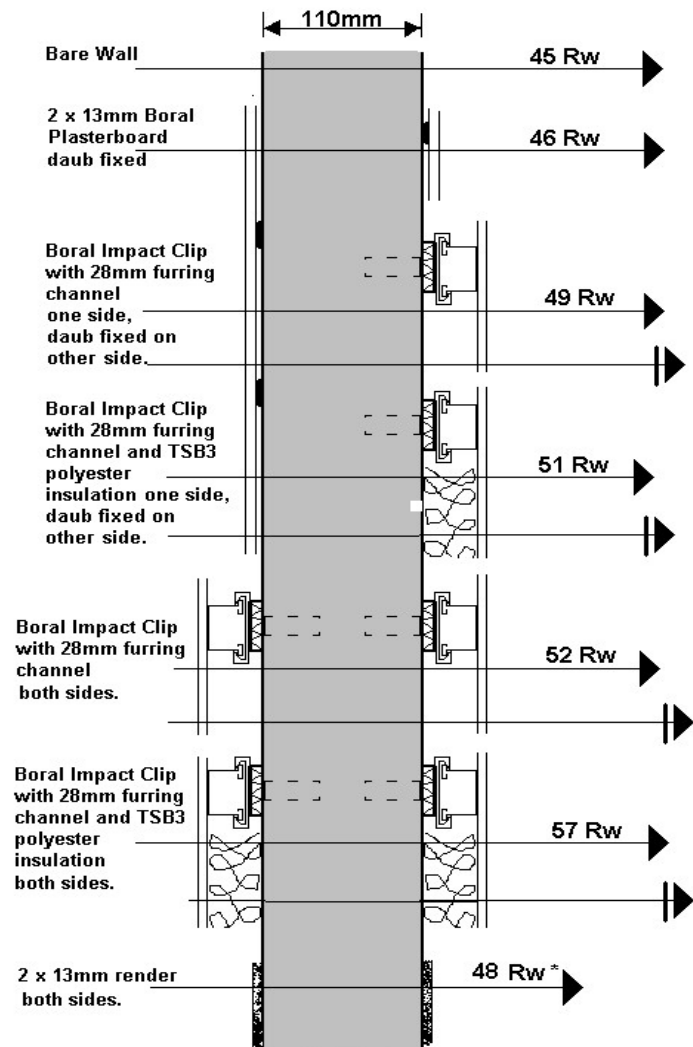

**DESCRIPTION:** 'Speed-E-Brick' double-height  
**PRODUCT CODE:** M12796WHNAT00ST  
**DIMENSIONS:** 110 x 162 x 230 mm (W x H x L) (+/- Tolerance to AS 4455)  
**STRENGTH:** Characteristic Unconfined Compressive Strength  $\geq 10$  MPa  
**FIRE RESISTANCE:** 120 /120/120 (Srf  $\leq 21.14$ )  
 – /240/180 (Srf  $< 25.83$ ) (non-loadbearing)  
**DURABILITY:** General Purpose  
**WEIGHT:** 6.0 Kg  $\pm 10\%$       **NO. PER PALLET:** 250 Units      **NO. PER M<sup>2</sup>:** 26.8 Units

## ACOUSTIC DESIGN:



Manufactured to AS/NZS 4455.1:2008.  
 Fire Resistance Levels as per Exova Warringtonfire Assessment Report #28339-00.  
 Acoustic tests to AS 1276 & AS1191, repeatability depends on workmanship, materials and methods being identical to those tested.  
 The information above is for general description purposes only.  
 12/02/2018 - subject to change without notice.

\* Opinion